

QUICKLOCK-TYPE CONNECTORS WITH INSULATED THROAT

FOR ARMORED CABLE, METAL CLAD AND FLEXIBLE METALLIC CONDUIT

APPLICATION:

- Used to connect MC, AC and Flex cable to box or enclosure.

FEATURES:

- No locknut required
- Single-unit or duplex construction with captive clamp.
- Connects 50 MC, AC and Flex RW cable sizes with just three fittings.
- Easy to install. Just tilt, insert and snap down.
- Single-unit construction eliminates loose component parts; integral green plastic insulated throat bushing provides maximum protection for wire installation.
- Concrete tight when taped and used with PVC jacketed cord.
- Accepts 2 cables of each size listed.

STANDARD MATERIALS:

Tubular Steel

STANDARD FINISH:

Zinc Plated

CERTIFICATIONS AND COMPLIANCES



UL LISTED E309514
UL Standard: UL514B
NEMA FB-1
ASTM Rated



TYPE QL-50

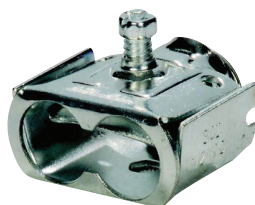
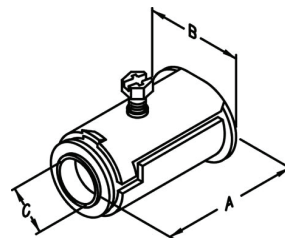

TYPE QL-50D

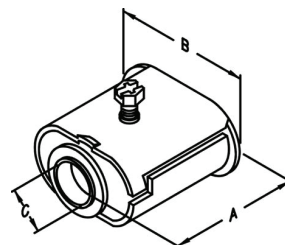
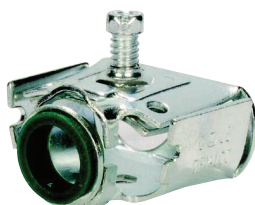

CATALOG NUMBER	TRADE SIZE	DIM A	DIM B	DIM C	UNIT PACK	MASTER PACK	LBS./ 100 PCS	UPC #
QL-50	1/2" SINGLE	1.438	0.438	0.438	50	500	8	90001
QL-75	3/4" SINGLE	1.313	0.563	0.563	25	125	14	90002
QL-50D	1/2" DUPLEX	1.688	0.563	0.563	25	125	10	90003

Please see Cable Chart for Cable Connectors on page 182.

