

ALUMINUM THREADED CONDUIT BODIES WITH COVER AND GASKET

FOR THREADED RIGID CONDUIT AND IMC

APPLICATION

To provide access to conductors for pulling, splicing, and maintenance. Threaded for rigid conduit and IMC

FEATURES

- Tapered threaded hubs (NPT)
- Assembled with neoprene gasket and stamped cover
- Die cast from high-strength, corrosion and weather resistant, copper-free aluminum alloy.
- Flat back design for easy mounting close to walls

STANDARD MATERIALS

1/2" - 2"
Die cast/Copper-free Aluminum
2-1/2" - 4"
Sand-cast/Copper-free Aluminum

STANDARD FINISH

Aluminum Enameled



TYPE LL1ACG

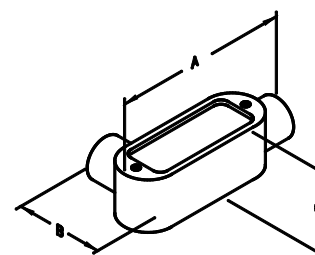

CATALOG NUMBER	TRADE SIZE	DIM A	DIM B	DIM C	MAX WIRE SIZE	VOL. CU.IN.	UNIT PACK	MASTER PACK	LBS. / 100 PCS.	UPC #
LL Type										
LL1ACG	1/2"	4.31	2.06	1.38	N/A	4.35	10	50	25	10089
LL2ACG	3/4"	5.06	2.25	1.63	3 #6 AWG	7.30	10	50	37	10090
LL3ACG	1"	5.87	2.63	1.88	3 #4 AWG	12.20	5	25	45	10091
LL4ACG	1-1/4"	7.81	3.63	2.50	3 #2 AWG	35.80	-	10	98	10092
LL5ACG	1-1/2"	7.81	3.63	2.50	3 #1/0 AWG	35.80	-	10	92	10093
LL6ACG	2"	10.06	4.44	3.38	3 #4/0 AWG	69.70	-	5	245	10094
LL7ACG	2-1/2"	12.81	5.75	4.00	3 #300 MCM	69.70	-	1	388	10095
LL8ACG	3"	12.81	5.75	4.50	3 #350 MCM	186.00	-	1	439	10096
LL9ACG	3-1/2"	15.62	11.69	5.63	3 #350 MCM	306.00	-	1	924	10097
LL10ACG	4"	15.62	11.69	5.63	3 #350 MCM	308.00	-	1	882	10098



TYPE LR1ACG

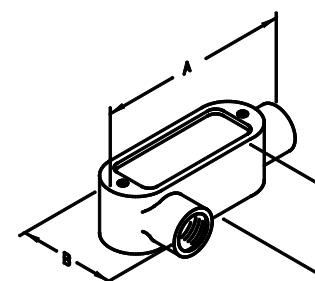

CATALOG NUMBER	TRADE SIZE	DIM A	DIM B	DIM C	MAX WIRE SIZE	VOL. CU.IN.	UNIT PACK	MASTER PACK	LBS. / 100 PCS.	UPC #
LR Type										
LR1ACG	1/2"	4.31	2.06	1.38	N/A	4.35	10	50	23	10099
LR2ACG	3/4"	5.06	2.25	1.63	3 #6 AWG	7.30	10	50	38	10100
LR3ACG	1"	5.87	2.63	1.88	3 #4 AWG	12.20	5	25	49	10101
LR4ACG	1-1/4"	7.81	3.63	2.50	3 #2 AWG	35.80	-	10	98	10102
LR5ACG	1-1/2"	7.81	3.63	2.50	3 #1/0 AWG	35.80	-	10	94	10103
LR6ACG	2"	10.06	4.44	3.38	3 #4/0 AWG	69.70	-	5	254	10104
LR7ACG	2-1/2"	12.81	5.75	4.00	3 #300 MCM	69.70	-	1	366	10105
LR8ACG	3"	12.81	5.75	4.50	3 #350 MCM	186.00	-	1	406	10106
LR9ACG	3-1/2"	15.62	11.69	5.63	3 #350 MCM	306.00	-	1	928	10107
LR10ACG	4"	15.62	11.69	5.63	3 #350 MCM	308.00	-	1	902	10108